

Seating options for the Hall of mirrors

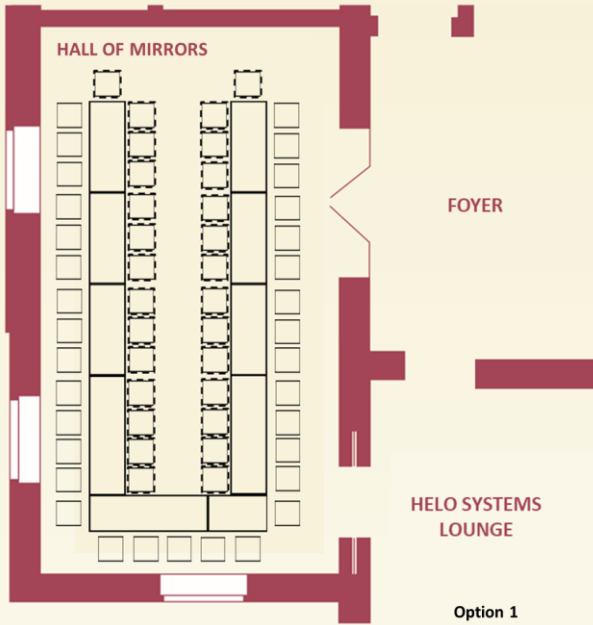

**Option 1**  
U-Arrangement  
up to 61 Person

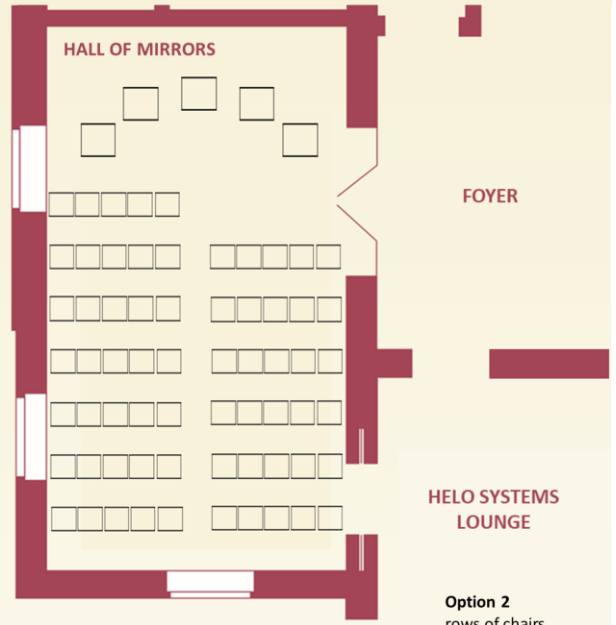

**Option 2**  
rows of chairs  
up to 65 Person

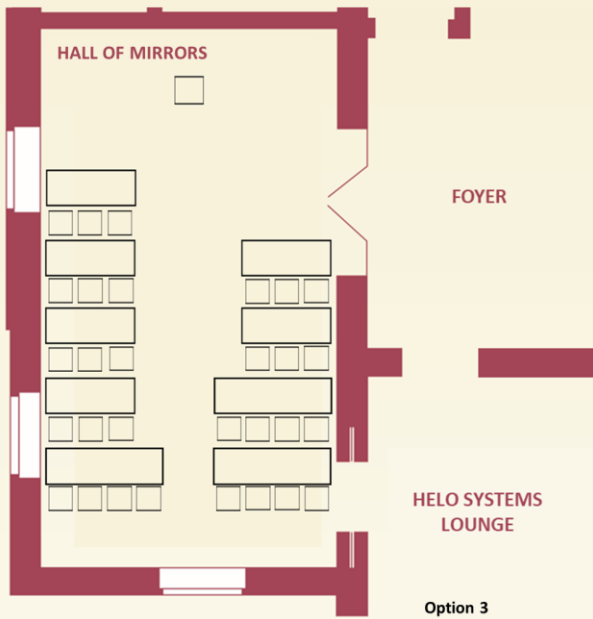

**Option 3**  
Parliamentary  
up to 30 Person

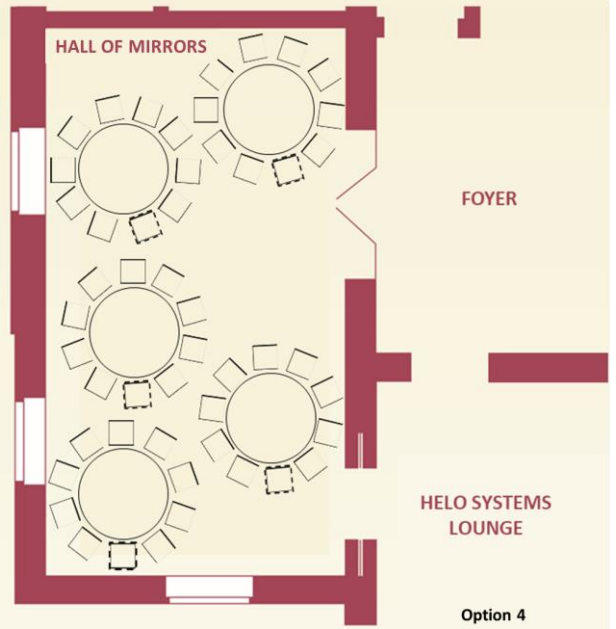

**Option 4**  
Banquet  
up to 50 Person

Seating options for the Hall of mirrors

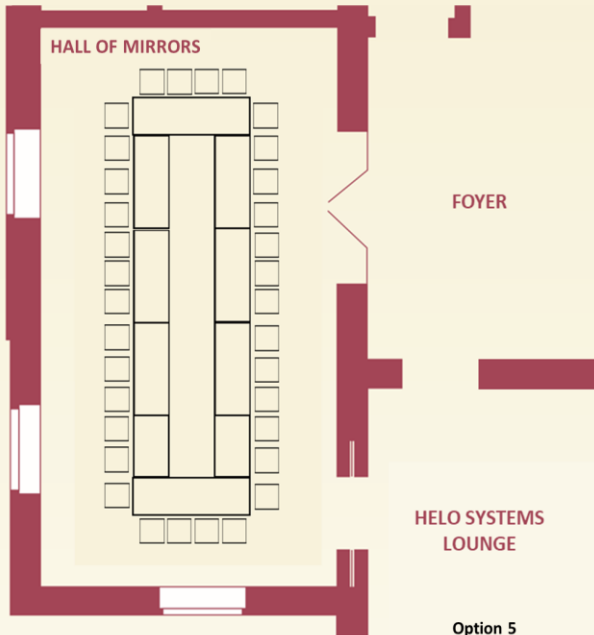

**Option 5**  
Block seating  
up to 34 Person

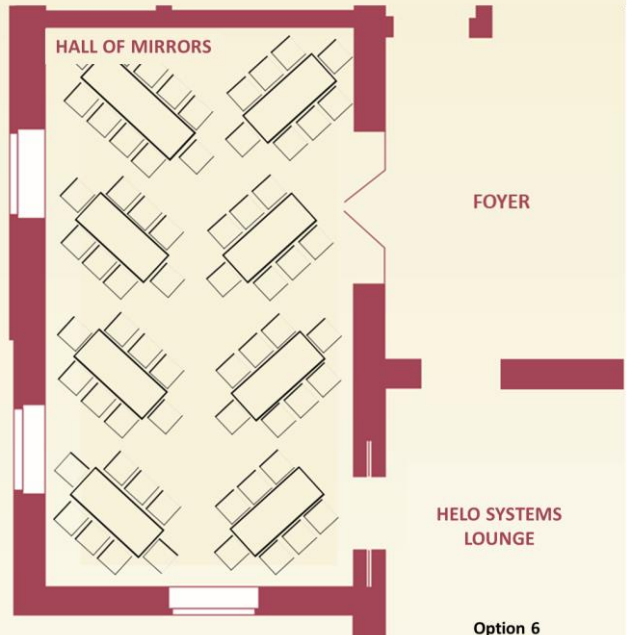

**Option 6**  
Fishbone  
up to 54 Person

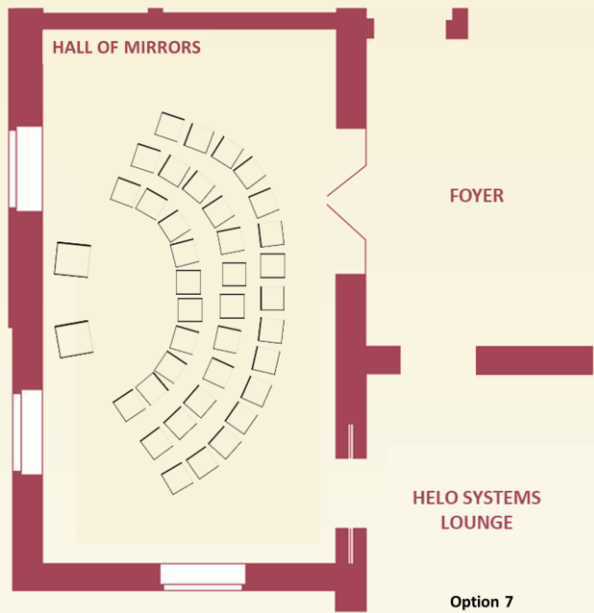

**Option 7**  
Semicircle  
up to 40 Person

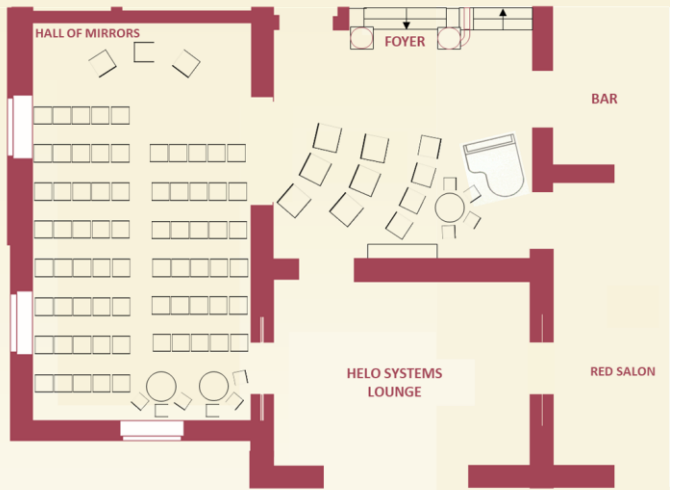

**Option 8**  
Rows of chairs + Foyer  
up to 90 Person

Seating options for the Red Salon

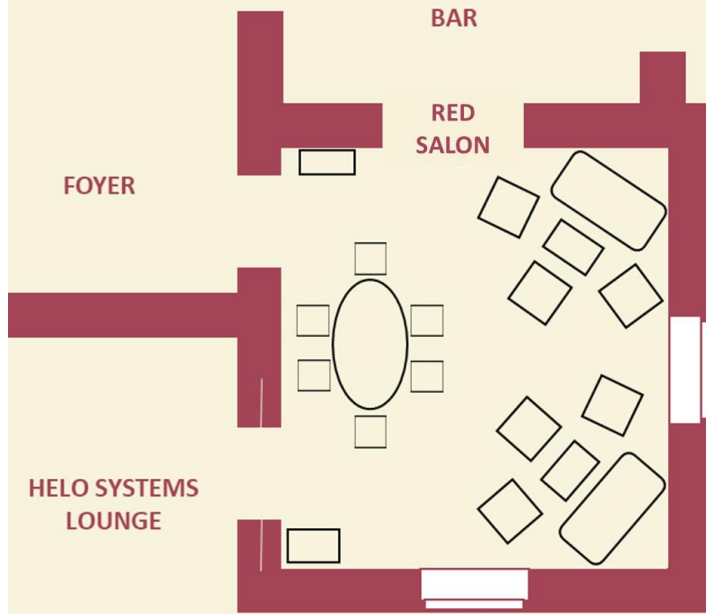

**Option 1**  
Lounge  
up to 16 Person

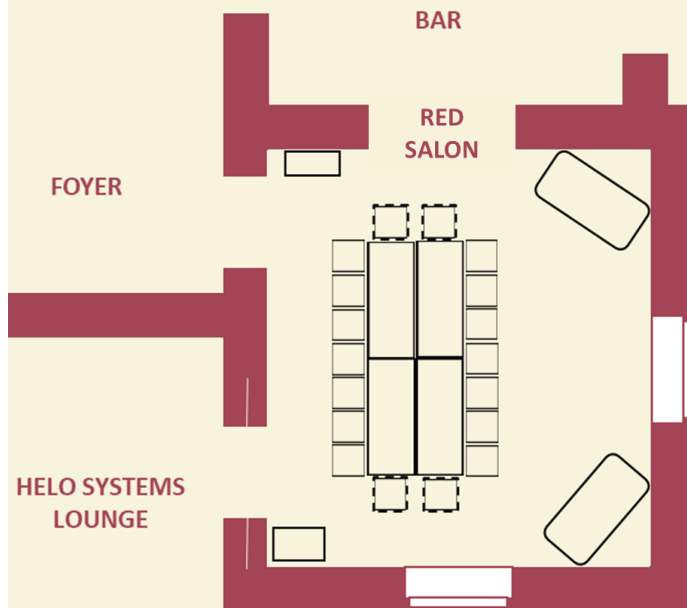

**Option 2**  
Block seating  
up to 18 Person

## Seating options for the Helo Systems Lounge

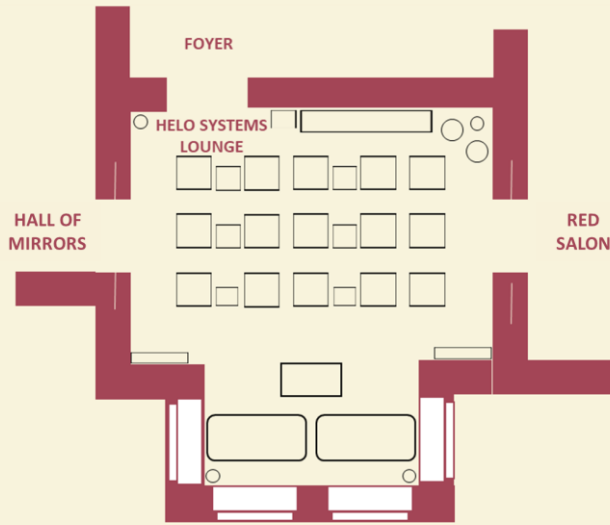

**Option 1**  
Lounge  
up to 19 Person

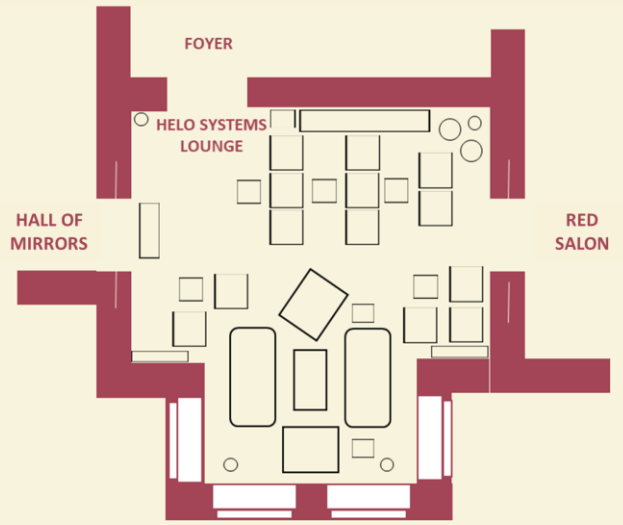

**Option 2**  
Lounge  
up to 20 Person

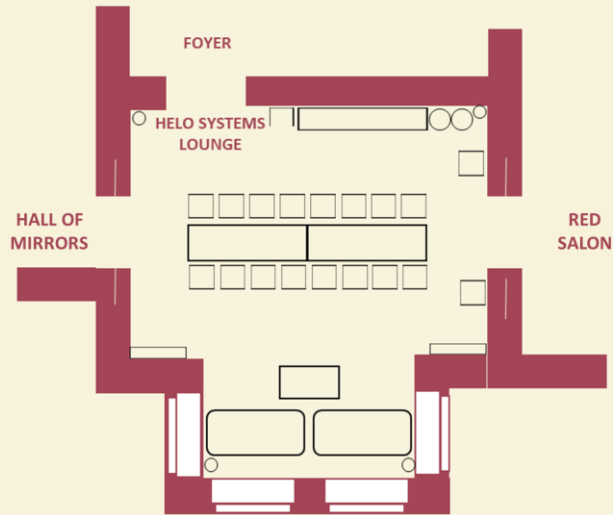

**Option 3**  
Table seating  
up to 16 Person